

Loch name ... LOCH OF BOSQUOY ... Island ... Mainland ... No. ... #2
 Grid Reference HY306185 ... Date surveyed ... 15.8.86 ...
 Loch size ... 26.64 ha. Altitude 5-10 m Secchi disk depthm
 Water colour CLEAR/CLOUDY Loch level upcm downcm
 Adjacent wetland ... GOOD TO WEST DN OTHER SIDES SI. GRAZING TO EDGE ...
 Loch status Type 7A ..

Substrate types

Substrate types	Sand (0.1-4mm diameter)
Bedrock ✓	<u>Silt</u> (< 0.1mm diameter) ✓
Boulders (> 30cm max diameter) ✓	Organic mud (black and smelly)
Stones (5-30cm diameter) ✓	Peat
Gravel (4-50mm diameter)	Artificial embankment

Uses and Damage

USE	AREA AFFECTED	DAMAGE
Water abstraction
Sewage inflow
Agricultural pollution ✓ ... <u>slight drain outflows</u>	<u>slight algal increase</u>
Edge trampling: animals ✓ ... <u>field at northern tip</u>	<u>cattle trampling</u>
: people
Fishing
Shooting ✓ ... <u>cartridges found on eastern shore</u>
Others

Fauna

Birds	Mammals	Molluscs	Dragonflies
<u>snipe</u> <u> Moorhen</u> <u> Mallard</u> <u> Coot</u> <u> Tufted duck</u>	<u> Otter spraint</u>	<u> Planorbis contortus</u> <u> P. Crista</u> <u> Planorbis jenkinsi</u> <u> P. laevis ?</u>	

Water chemistry

Water sample taken No. ... 1 ... Time spent on site ... 3 hrs x 2 ...
 Conductivity ... 365 μmhos

S1911 S1011 S141

Map code	Species	DAFOR	Map code	Species	DAFOR
Ags	<u>Agrostis stolonifera</u>	A..	Pha	<u>Phragmites australis</u>
Api	<u>Apium inundatum</u>	Pam	<u>Polygonum amphibium</u> Marsh	..O..
Cah	<u>Callitriche hamulata</u>	Pbe	<u>Potamogeton berchtoldii</u>
Cher	<u>Callitriche hermaphroditica</u> (washed-up)	..A?	Pcr	<u>Potamogeton crispus</u>
Cpla	<u>Callitriche platycarpa</u>	Pfil	<u>Potamogeton filiformis</u>	..A..
Cas	<u>Callitriche stagnalis</u> Edge	..O...	Pfr	<u>Potamogeton friesii</u>	..F..
Cap	<u>Caltha palustris</u> Edge Marsh	..A..	Pgr	<u>Potamogeton gramineus</u>	..LA.
Cxn	<u>Carex nigra</u> Edge Marsh	..F..	Pn	<u>Potamogeton natans</u>	..LF.
Cxro	<u>Carex rostrata</u>	PXn	<u>Potamogeton X nitens</u>
Elp	<u>Eleocharis palustris</u> Edge	F/LA	Pob	<u>Potamogeton obtusifolius</u>
Era	<u>Eriophorum angustifolium</u>	Ppec	<u>Potamogeton pectinatus</u>	..O/LD
Glf	<u>Glyceria fluitans</u>	Pper	<u>Potamogeton perfoliatus</u>	..O..
Hip	<u>Hippuris vulgaris</u>	Ppol	<u>Potamogeton polygonifolius</u>
Hyd	<u>Hydrocotyle vulgaris</u> Marsh	..A..	Ppu	<u>Potamogeton pusillus</u>	..O..
Ip	<u>Iris pseudacorus</u> Marsh	..LF..	Pop	<u>Potentilla palustris</u> Marsh	..LA (Pools)
Ja	<u>Juncus articulatus</u> Edge Marsh	..A..	Ra	<u>Ranunculus aquatilis</u>
Jb	<u>Juncus bulbosus</u>	Rb	<u>Ranunculus baudotii</u>
Je	<u>Juncus effusus</u> Edge Marsh	..O..	Rfl	<u>Ranunculus flammula</u> Edge Marsh	..F..
La	<u>Leana minor</u>	Rhe	<u>Ranunculus hederaceus</u>
Lit	<u>Littorella uniflora</u>	..O..	Rtr	<u>Ranunculus trichophyllus</u>
Ma	<u>Mentha aquatica</u> Edge Marsh	..F..	Ris	<u>Rorippa islandica</u>
Mt	<u>Menyanthes trifoliata</u> Marsh	..O..	Sf	<u>Scirpus fluitans</u>
Mg	<u>Mimulus guttatus</u>	Sl	<u>Scirpus lacustris</u>	..LD..
Mon	<u>Montia fontana</u>	St	<u>Scirpus tabernaemontani</u>
Myl	<u>Myosotis laxa/caespitosa</u> Marsh	..O..	Spa	<u>Sparganium angustifolium</u>
Msc	<u>Myosotis scorpioides</u>	Spe	<u>Sparganium erectum</u> Edge	..LA..
Mal	<u>Myriophyllum alterniflorum</u>	Uti	<u>Utricularia intermedia</u>
Msp	<u>Myriophyllum spicatum</u>	O/LA	Um	<u>Utricularia minor</u>
Mes	<u>Nasturtium officinale</u>	Uva	<u>Utricularia vulgaris/australis</u>
Pa	<u>Phalaris arundinacea</u>	Une	<u>Utricularia neglecta</u>

Map code	Species	DAFOR	
Vb	Veronica beccabunga	Zani. Zannichellia palustris.....O..
Vaa	<u>Veronica anagallis-aquatica</u> Edge	..R..Epiphytic algae.....D..
Vs	Veronica scutellatafilamentous algae.....LA..
Ef	<u>Equisetum fluviatile</u> Edge	..lf..
Ep	<u>Equisetum palustre</u> Edge/Marsh	..F..
Cha	<u>Chara spp.</u>	..LD
Nit	Nitella spp.
Fon	<u>Fontinalis antipyretica</u>	..F..

No charophyte specimen collected for verification

Vegetation Map

LOCH OF BOSQUOY 2.

1: 2,500

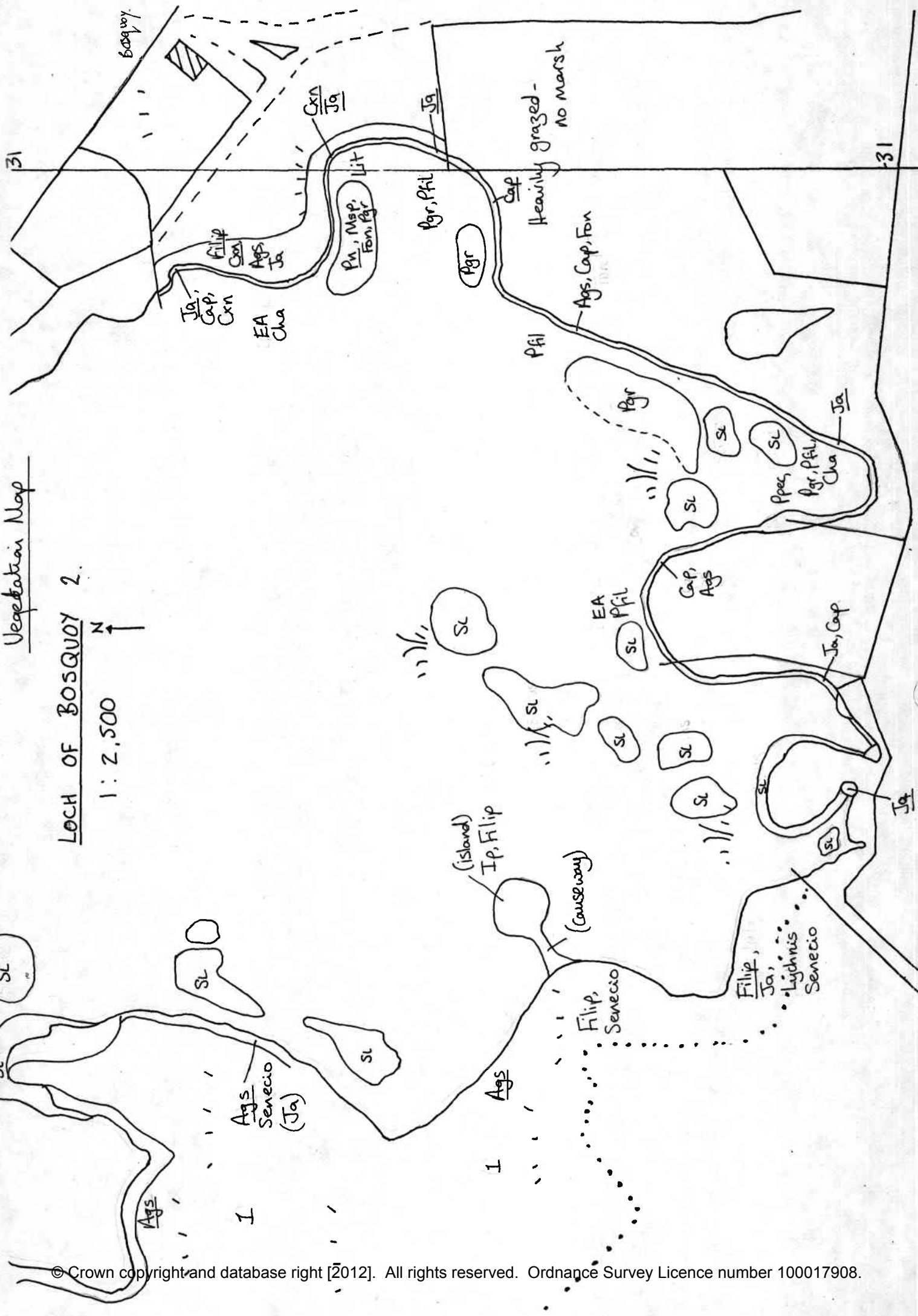

Vegetation Map

LOCH OF BOSQUOY I.

1: 2,500

31-

Wygat

N ↑

KNOWE OF BOSQUOY

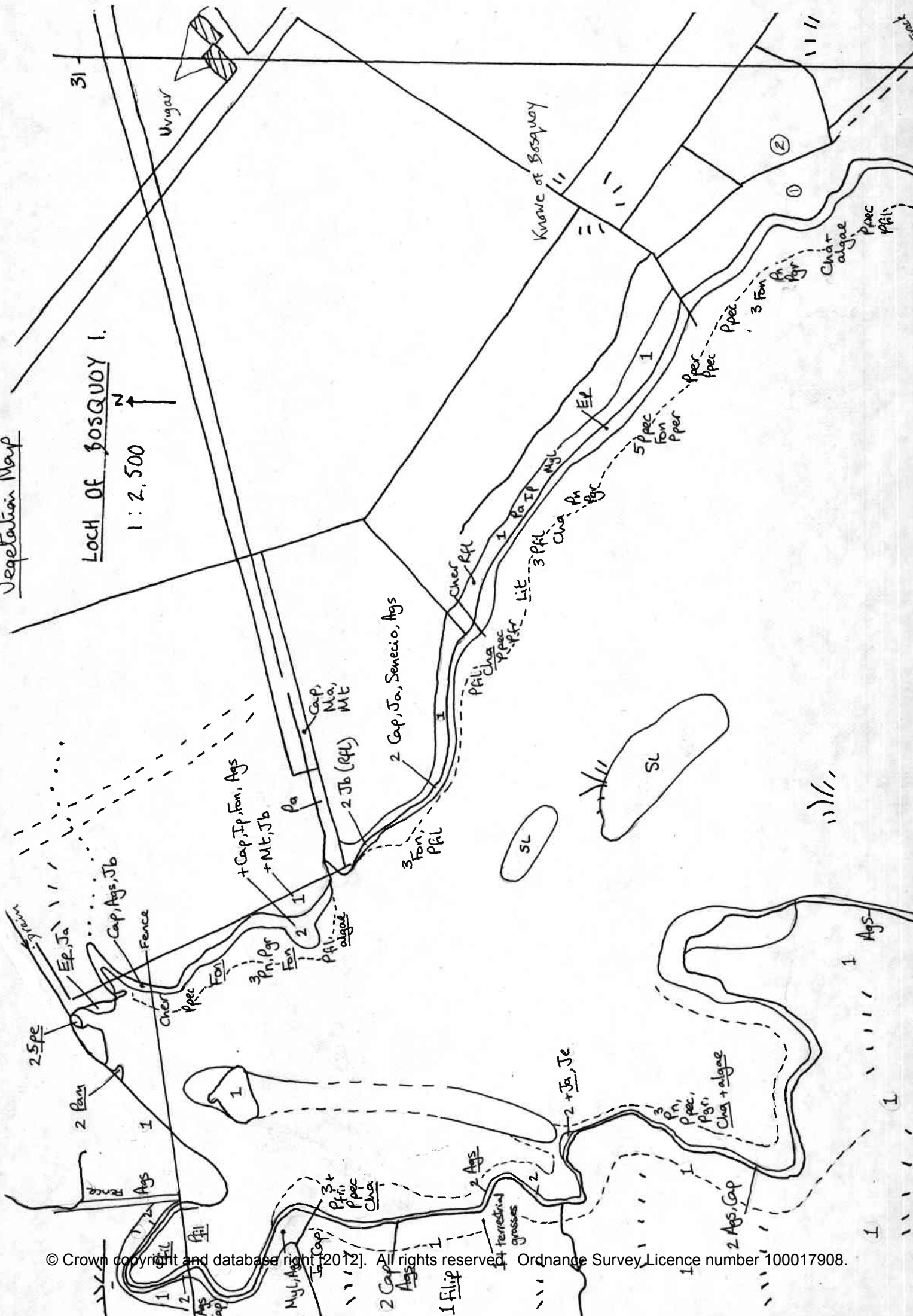

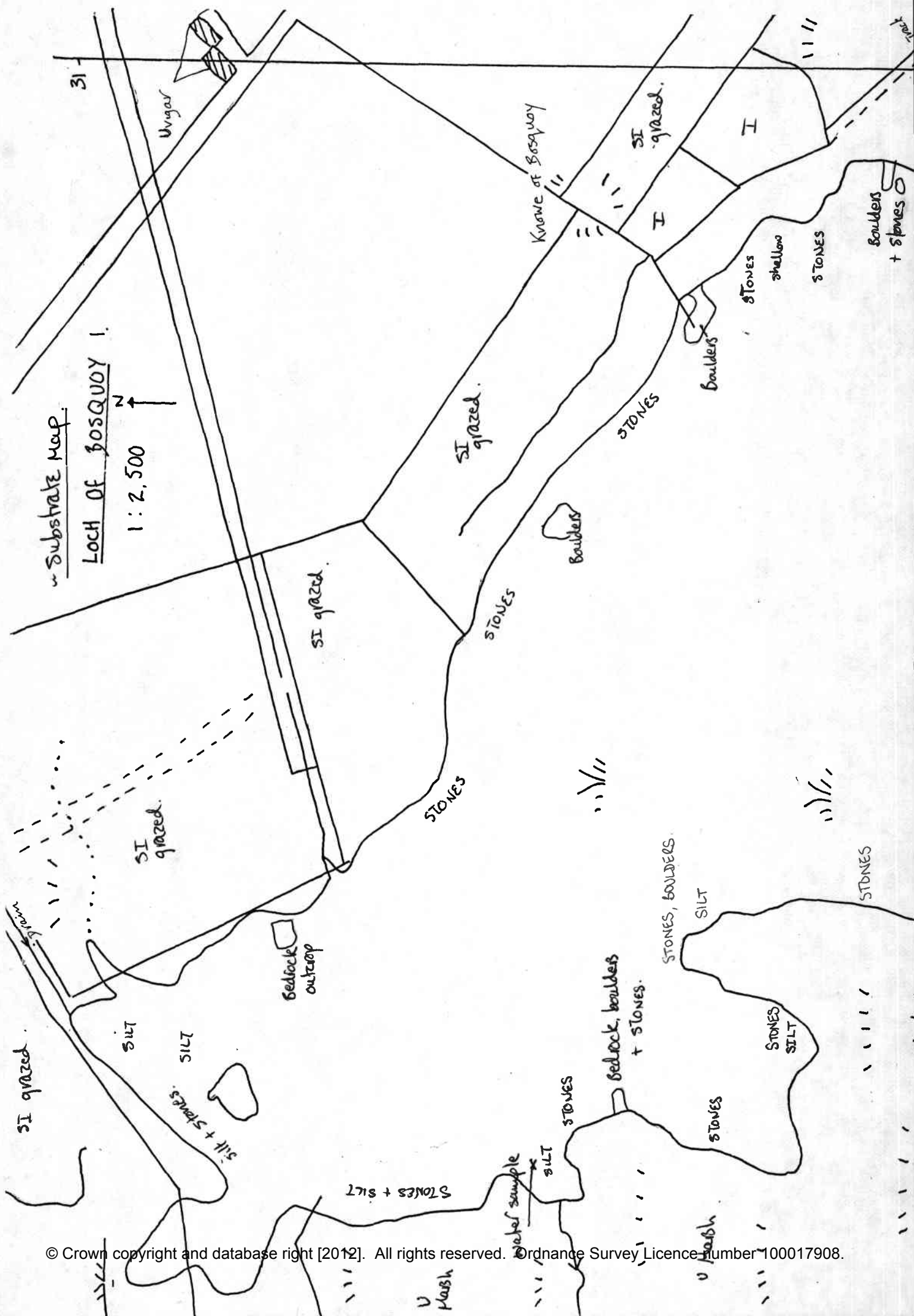

Loch of Bosquoy 2. Substrate

1: 2,500

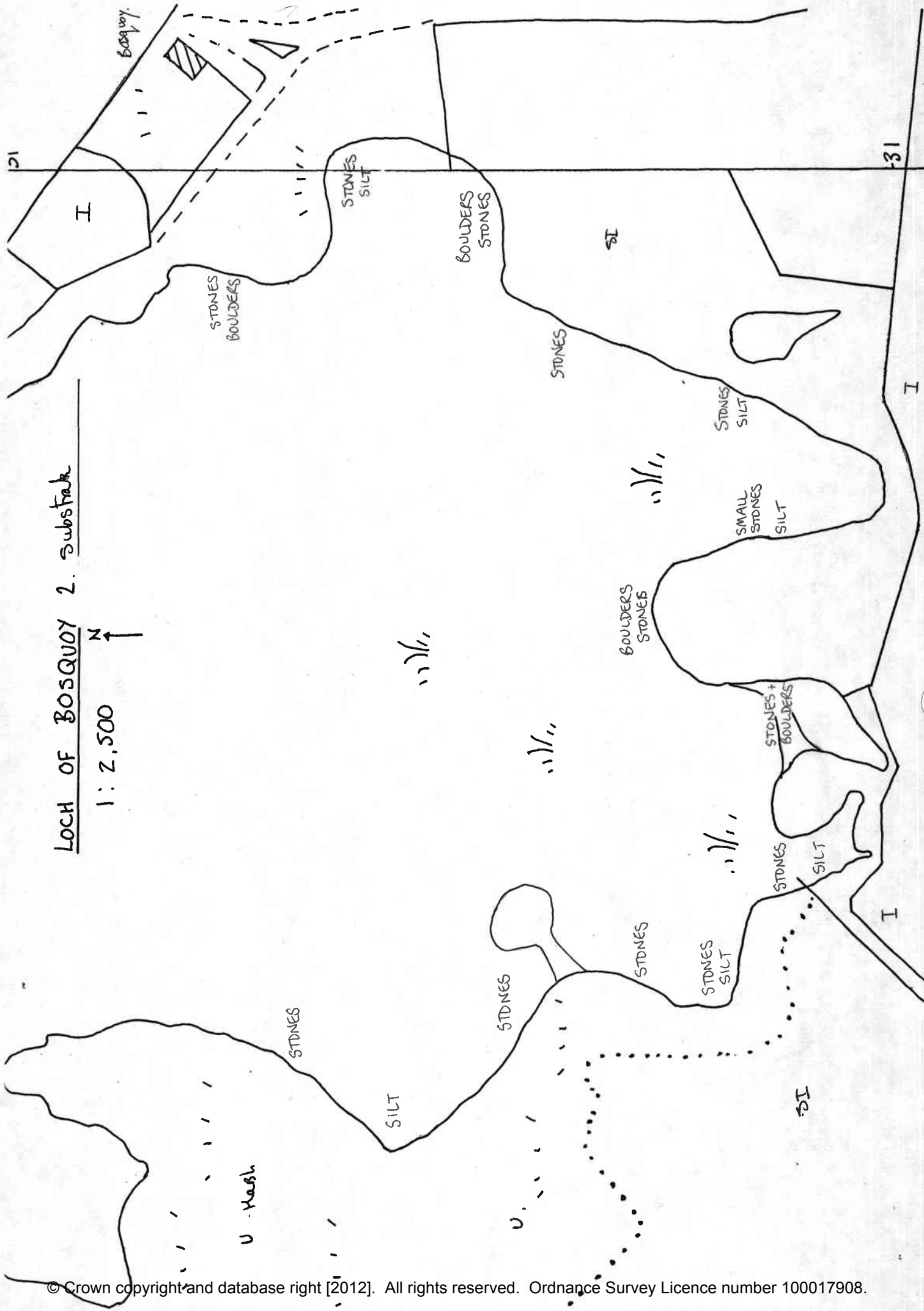
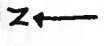

Adjacent Land Use Map



Plant Communities

Loch type V

7A.

1. Marsh

The marsh area is best developed on the western side though a grassland margin occurs between the marsh community and loch edge. This marshland area is dominated by Filipendula ulmaria with abundant Caltha palustris. Within this community and grassy margin, Agrostis stolonifera, Juncus articulatus and Carex nigra occur frequently with occasional Ranunculus flammula, Equisetum palustre, Mentha aquatica, Myosotis caespitosa, Polygonum amphibium, Senecio aquaticus, Lychnis flos-cuculi and Rumex sp.

The north east and southern margins support very little marsh vegetation with semi-improved grazing land extending to the loch shore. A narrow strip along the eastern margin supports occasional Iris pseudacorus, Phalaris arundinacea, Myosotis caespitosa and Ranunculus flammula.

2. Edge

A sparse edge community with occasional patches of Agrostis stolonifera, Caltha palustris, Juncus articulatus, Carex nigra and Polygonum amphibium. Eleocharis palustris and Equisetum fluviatile occur occasionally, particularly in sheltered bays. Scirpus lacustris occurs occasionally at the edge as well as open water. Sparganium erectum is also present.

3. Open Water

Dominated by Epiphytic algae with occasional Chara sp, Fontinalis antipyretica and Littorella uniflora. Occasional patches of Potamogetons occurred throughout the loch margin area particularly in the south and west; ie P natans, P gramineus, P filiformis, and P pectinatus.

Large patches of Scirpus lacustris (S8a Scirpetum lacustris) occur particularly in the southern region of the loch. Callitriche hermaphroditica was frequently found washed up and was occasionally found growing.

A large area of Potamogeton pectinatus was found growing in a disused drainage channel at the northern tip.